

Feature :



- Noiseless, conductive rubber
- Light click feeling
- Full color LED illuminated available
- Long electrical life cycles

Application :

- Audio / video products
- Instrumentation
- Communication equipments



SWITCH SPECIFICATIONS	
POLE - POSITION	OFF - <ON> for Momentary Type , SPST
CONTACT RATING	MAX : 1mA , 20VDC or 5mA , 5VDC MIN : 1mA , 5VDC
CONTACT RESISTANCE	200 Ω MAX.
INSULATION RESISTANCE	100 MQ MIN. 100 V DC
DIELECTRIC STRENGTH	Breakdown is not Allowable ; 250 V AC for 1 Minute
OPERATING FORCE	125 ± 35 gf
OPERATING LIFE	1,000,000 cycles
OPERATING TEMPERATURE RANGE	-40°C ~ 85°C
TOTAL TRAVEL	1.25 ± 0.3 mm

LED SPECIFICATIONS								
	Unit	Value / LED Color						
		Blue	Pure Green	Red	Yellow (5mA)	Orange	Green	White
 ATTENTION LEDs are Electrostatic Sensitive devices 								
LUMINOUS INTENSITY@20mA I _v	mcd	240	1000	180	24	250	50	400
Dominant Wavelength λ _D	nm	470	525	630	549	601	567	/
FORWARD VOLTAGE@20mA V _f	V	3.3	3.3	1.95	1.8	2.1	2.1	3.3

■ A single bin cannot be ordered, please contact us in advance if you need a particular bin sorting before placing your order to clarify the lead time, MOQ and pricing

HOW TO ORDER

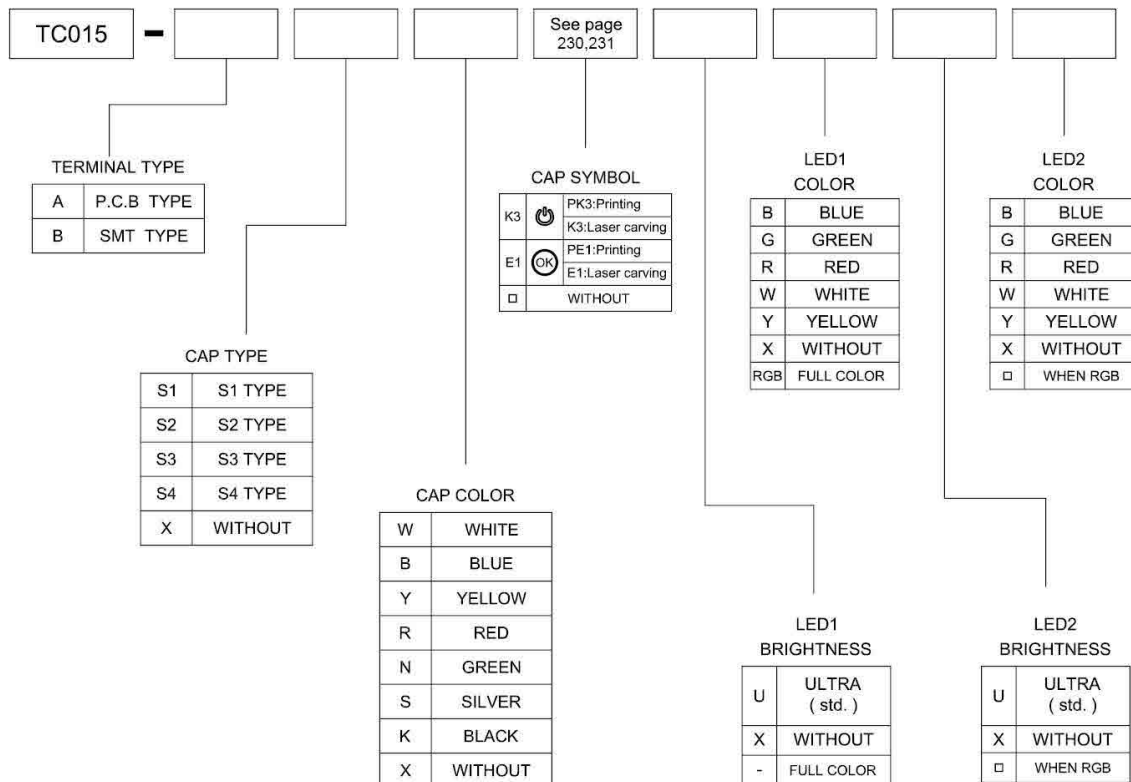

● **TERMINAL TYPE**

• TC015-AXX □□□□

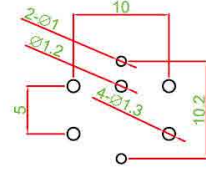
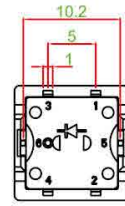
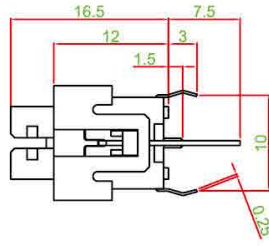
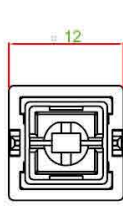

• TC015-BXX □□□□

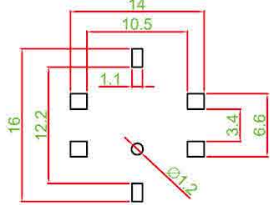
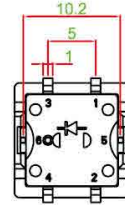
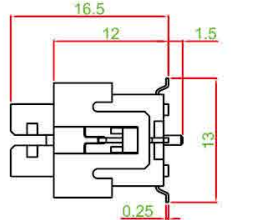
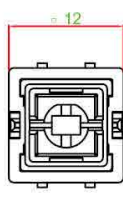

• TC015-AXX-RGB

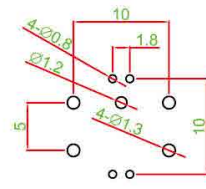
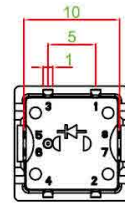
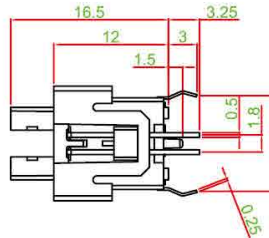
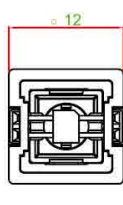

• TC015-BXX-RGB

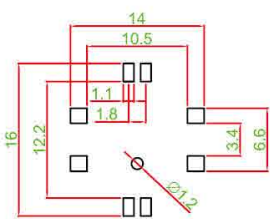
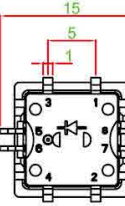
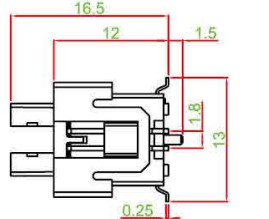
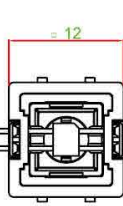

● **CAP TYPE**

S1 TYPE

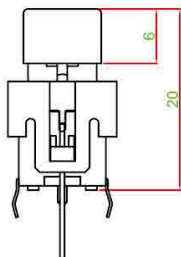
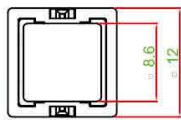

S2 TYPE

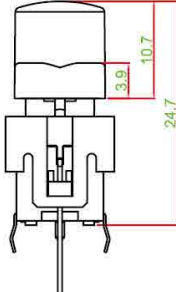
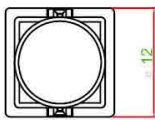

S3 TYPE

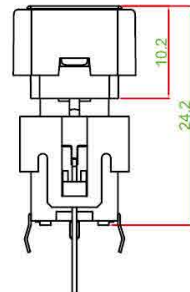
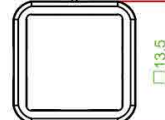

S4 TYPE

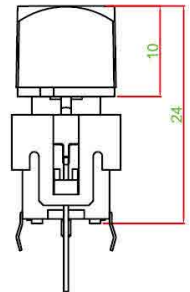
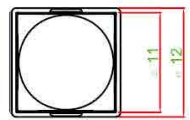

● **CIRCUIT**

SINGLE COLOR

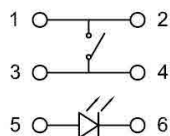

TWO COLOR

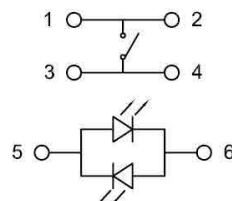

FULL COLOR

